

## Product Details

### E406 Non-Trapped Body

### Technical Data

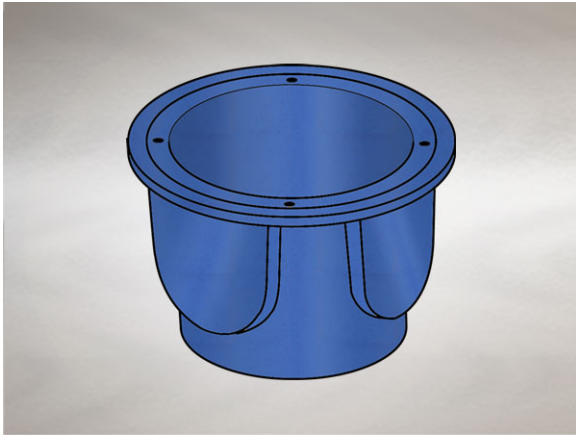

**Dimensions:**

405 dia. body

280 - Height below Body Flange

-35 to 15 - add to overall grating/cover height for min/max height between body flange and FFL

**Connection** - female 6" BSP threaded connection (150mm)

**Free Area** - 176cm<sup>2</sup>

**Materials** - Cast iron, lacquered

**Weight** - 29 kg

**Note:** Membrane clamping collar C.E2 also required if using with a Multi-Level top. (priced separately from body)

**General Description:**

Cast Iron E series Multi-Level Non-Trapped Body (Deep Sump plus Optional Side Inlets), with 6" BSP dia. vertical outlet. E Series Multi-Level gullies are suited for plant rooms, yards, car parks etc.

**Materials:**

**Cast Iron - BS EN 1561:** Used for bodies, membrane clamping collars, spigot adaptors and accessories such as extensions. A widely used metal in the drainage industry, its resistance to corrosion permits extended use under extreme conditions. Castings are coated with a high grade lacquer paint to provide internal and external surface coverage. Paint will gradually wear off and is replaceable; oxidisation (surface rusting) is a natural process which does not weaken the material. A zinc anti-corrosion coating is applied to certain castings by sherardizing.

---

All dimensions are in millimetres unless stated. In line with general practice all dimensions shown are nominal.

Wade International

Third Avenue, Halstead, Essex, CO9 2SX.

Telephone: +44 (0)1787 475151

Fax: +44 (0)1787 475579

e-mail: [wadetech@alumascwms.co.uk](mailto:wadetech@alumascwms.co.uk)

website: <https://www.alumascwms.co.uk/brands/wade/>

**Typical Installation for E406:**

Note: This illustration may show a similar Wade Product - it is intended to show the general installation type only.

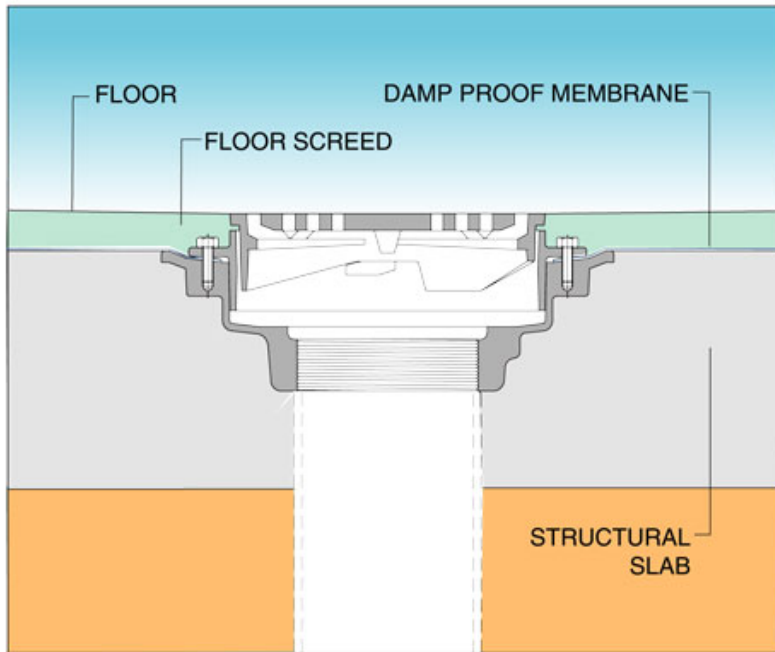

**Dimensioned Section for E406:**

